



INCORPORATED COUNTY OF LOS ALAMOS

101 Camino Entrada, Building 3
Los Alamos, New Mexico 87544 (505) 662-8056
Procurement Division

February 23, 2024

TO ALL HOLDERS OF SOLICITATION DOCUMENTS FOR

Invitation for Bids No. IFB24-40
IFB Name: DP Road Phase II Reconstruction Project

Addendum No. 2

This Addendum No. 2 forms a part of the Solicitation Documents and modifies, as noted below, the original Solicitation Documents identified above. This Addendum as well as all documentation associated with it shall be made available at the following link:

<https://www.losalamosnm.us/Doing-Business/Procurement/IFB24-40-DP-Road-Phase-II-Reconstruction-Project>

The drawings can be found at the following link: <https://losalamosnm.egnyte.com/dl/7xqXuPJgua>

This Addendum provides the following information:

Plan Sheet 2.2 was inadvertently left out of Addendum No. 1 and is attached, hereto.

All other provisions of the Solicitation Documents shall remain unchanged. This Addendum No. 2 is hereby made a part of the Solicitation Documents to the same extent as those provisions contained in the original documents and all itemized listings thereof.

Each Bidder is requested to acknowledge receipt of this Addendum No. 2 with the Bid Forms.

I hereby acknowledge receipt of this Addendum No. 2.

Signed

Print Name

Date

Title

Company

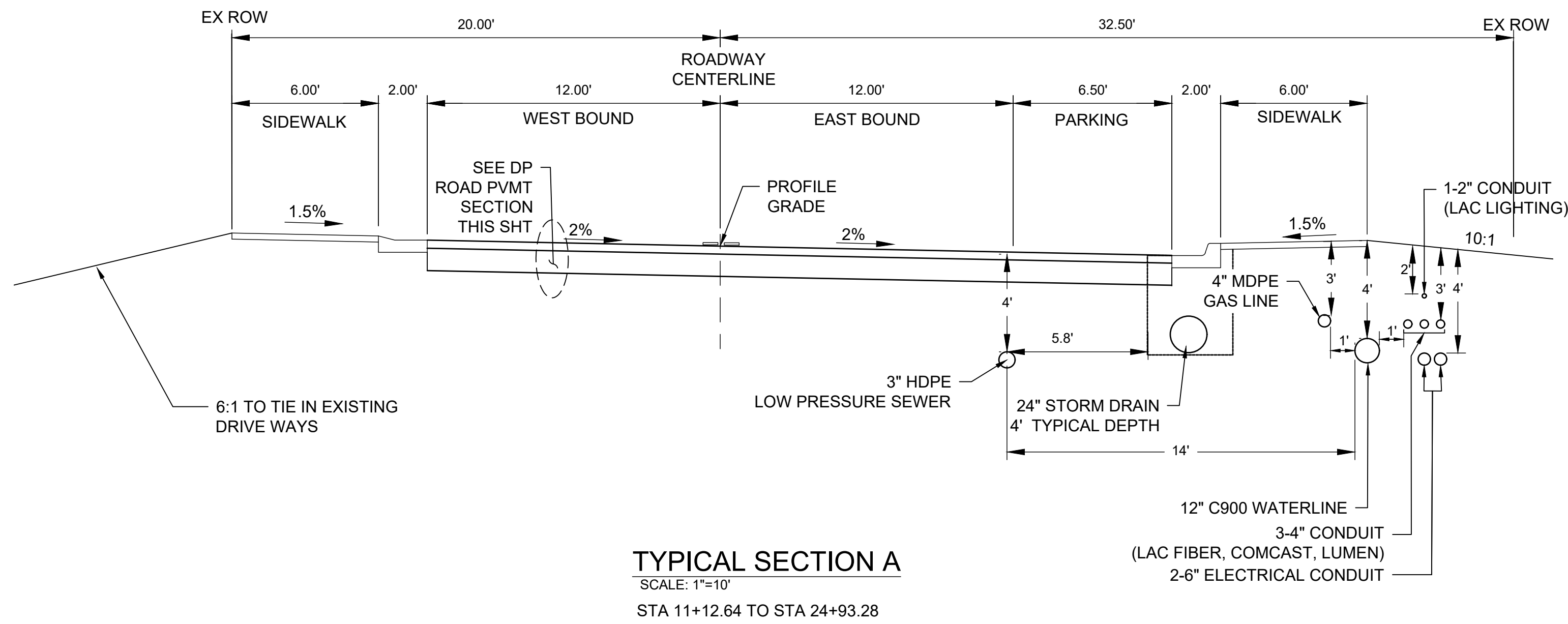

TYPICAL SECTION A
SCALE: 1"=10'
STA 11+12.64 TO STA 24+93.28

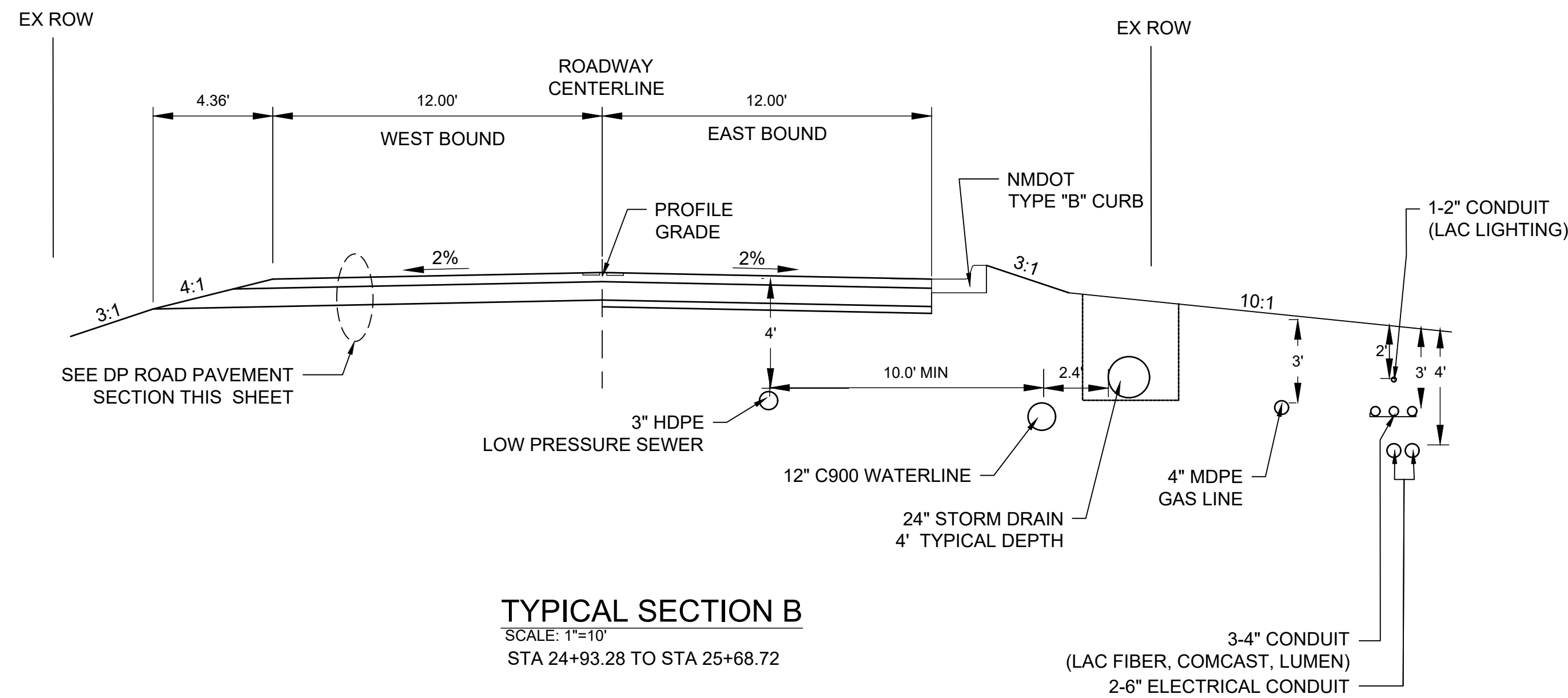

TYPICAL SECTION B
SCALE: 1"=10'
STA 24+93.28 TO STA 25+68.72

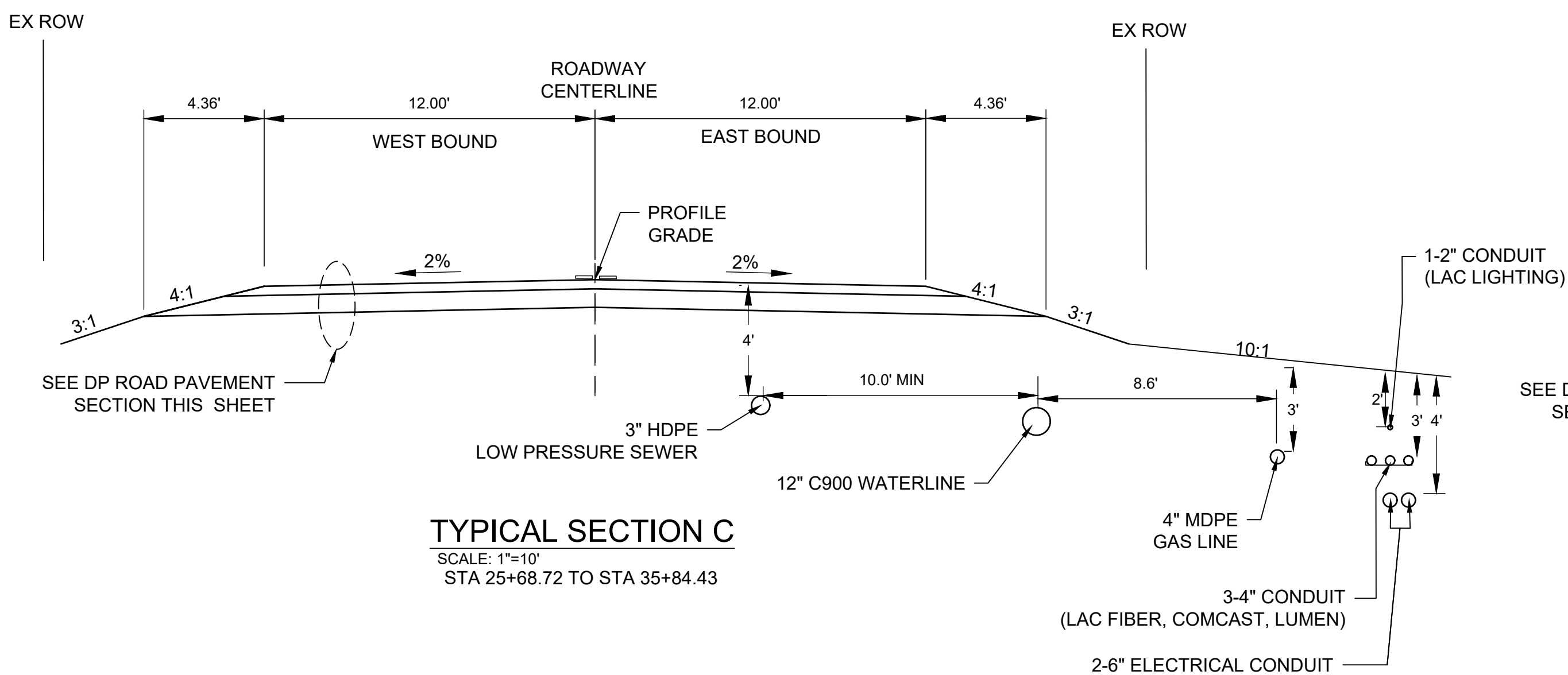

TYPICAL SECTION C
SCALE: 1"=10'
STA 25+68.72 TO STA 35+84.43

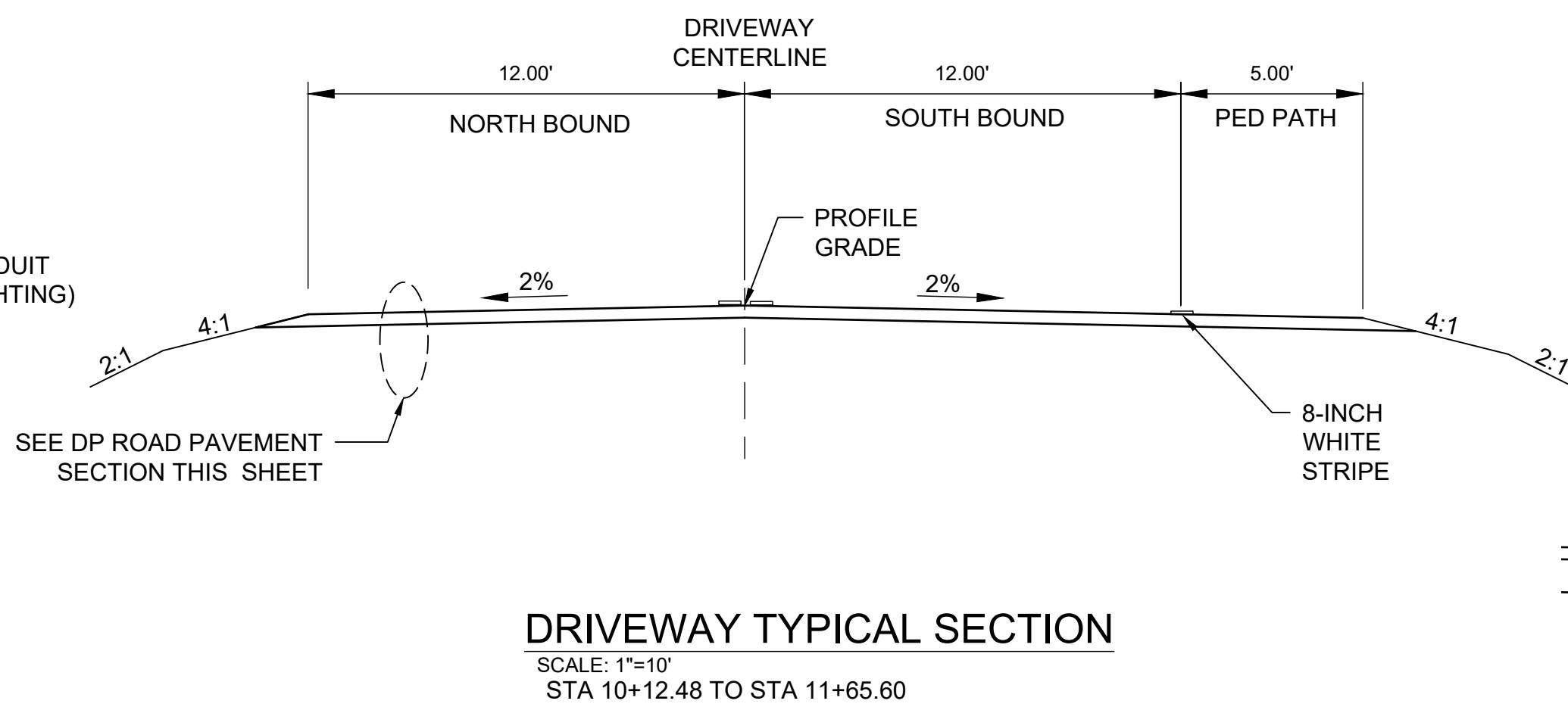

DRIVEWAY TYPICAL SECTION
SCALE: 1"=10'
STA 10+12.48 TO STA 11+65.60

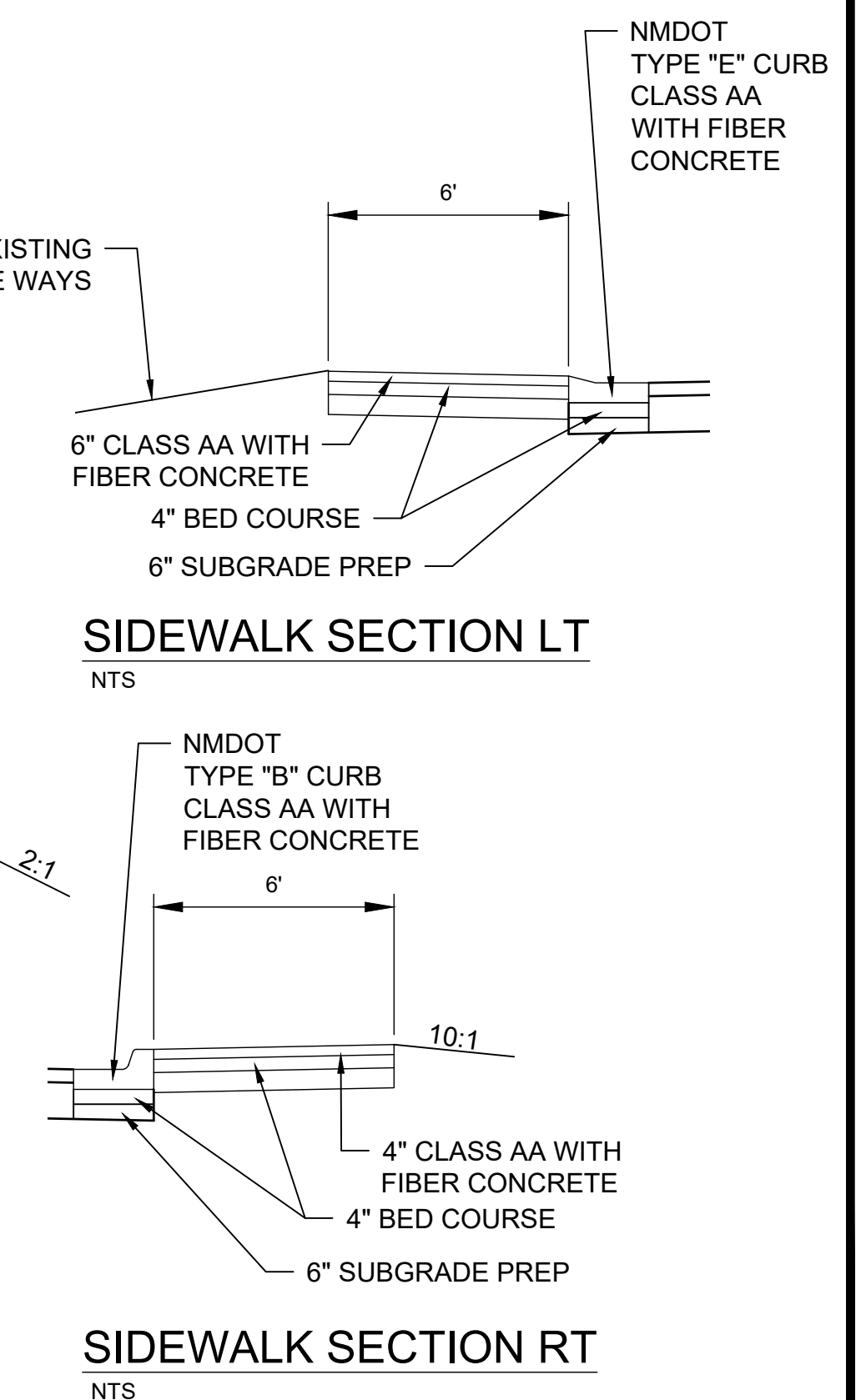

SIDEWALK SECTION RT
NTS

DP ROAD IMPROVEMENTS	
GEOMETRIC DESIGN CRITERIA	
DESIGN SPEED	30 MPH
STOPPING SIGHT DISTANCE (SSD)*	200'
POSTED SPEED	25 MPH
HORIZONTAL ALIGNMENT	
MAXIMUM DEGREE OF CURVATURE	375
MAXIMUM SUPERELEVATION	4%
VERTICAL ALIGNMENT	
MAXIMUM GRADE	6%
MINIMUM GRADE	0.50%
MINIMUM K-VALUE SAG	37
MINIMUM K-VALUE CREST	19
CROSS SECTION	
LANE WIDTH	12'
OUTSIDE SHOULDER	0'
CROSS SLOPE	2%
CLEAR ZONE (4:1 FILL SLOPE)	
DISTANCE FROM EDGE OF DRIVING LANE & END OF RECOVERY AREA	7'
*SSD DEPENDENT ON GRADE	

WILSON & COMPANY

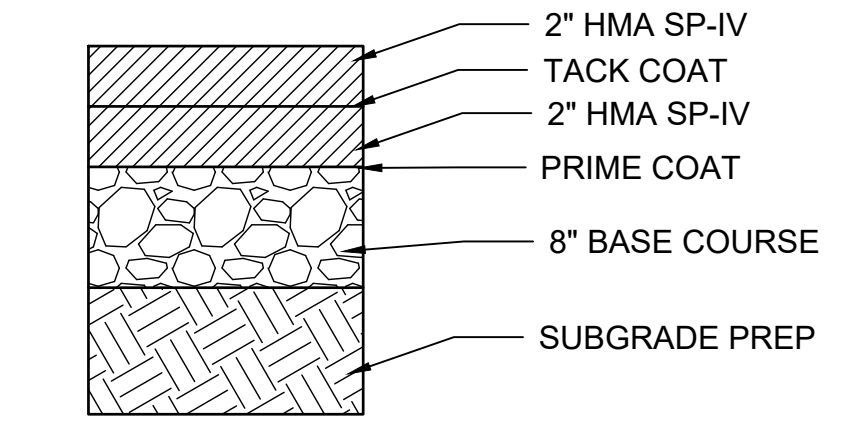

DP ROAD PAVEMENT SECTION
NTS

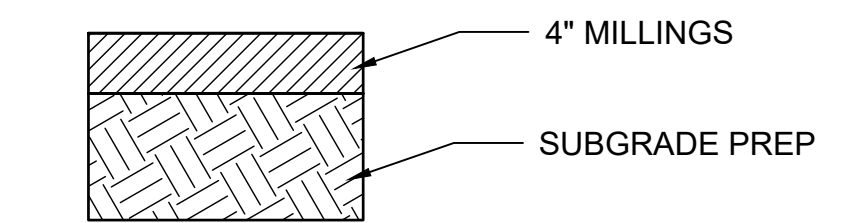

PARKING LOT PAVEMENT SECTION
NTS

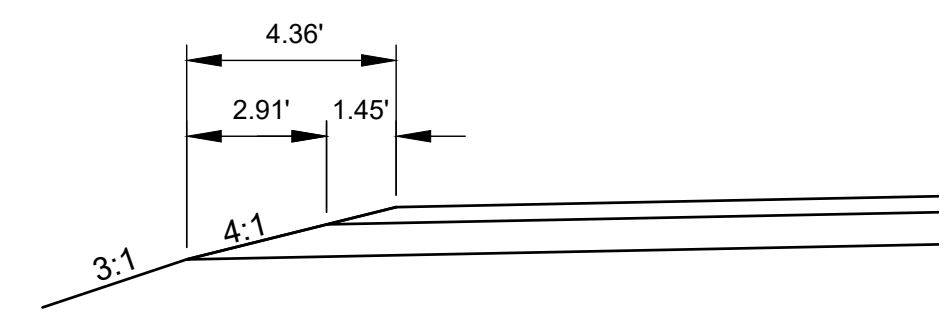

TAPER DETAIL
NTS

M:\TRN\17-100-005-07_2_DISCIPLINES\SHEETS_3_SHEETS - ROADWAY\PLANS\2_SHEETS_C-TYP-01.DWG 2/23/2024 4:25 PM

NO.	REVISION DESCRIPTION	DATE	BY
5			
4			
3			
2			
1			



DESIGNED BY: C.L.	DRAWN BY: D.A.P.	CHECKED BY: E.S.C.	APPROVED BY: [Signature]
			DATE: DECEMBER 2023
			SCALE:

DP ROAD PHASE II
PROJECT BID NO. IFB 24-40
PROPOSED TYPICAL SECTION



COUNTY OF LOS ALAMOS
PUBLIC WORKS DEPARTMENT
1000 CENTRAL AVE
LOS ALAMOS, NEW MEXICO 87544